

alber

Simply mobile.

# scalamobil® scalacombi

Mobile stair climbers

“Upstairs,  
downstairs – we can  
finally manage it!”

**USING STAIRS  
THE EASY WAY.**

# Finally no more obstacles in the way – thanks to scalamobil and scalacombi

## Climbing stairs easily and safely – proven thousands of times

Every single step becomes an obstacle when an illness or disability stops you climbing the stairs on your own: at home, at the surgery, in public buildings or when visiting friends and family. The mobile stair climbers from Alber – scalamobil and scalacombi – remove the obstacles from your path.

## And this is how it works ...

Two electrically driven pairs of wheels continually climb one step after the next – upwards and downwards. This is ensured by a gentle yet reliable climbing mechanism – patented by Alber. When descending the stairs, four safety brakes stop scalamobil and scalacombi automatically at the edge of each step. The carer selects the direction and speed. When scaling the stairs, he or she only has to keep the stair climber in balance.

You can also watch a film about scalamobil and scalacombi on the Internet at [www.alber.de](http://www.alber.de).



Go to the film here

## The product benefits at a glance

- ▶ Also able to cope with narrow and spinal staircases – at home and elsewhere
- ▶ Functions on any floor covering – whether wood, stone, metal or carpeting
- ▶ No damage to stairs or floor covering
- ▶ ErgoBalance grips for safe operation with minimum exertion
- ▶ Climbs up to 300 steps with a single battery charge
- ▶ With integrated safety sensors





**“Finally we can go  
anywhere with the  
wheelchair!”**





# scalamobil®

## Climb the steps in your own wheelchair

The scalamobil fits most common wheelchair models. The great advantage: you can stay seated in your wheelchair to climb the stairs.

1. A special bracket is fitted to your wheelchair and the scalamobil is attached when needed. This device does not restrict the folding mechanism or other wheelchair settings.

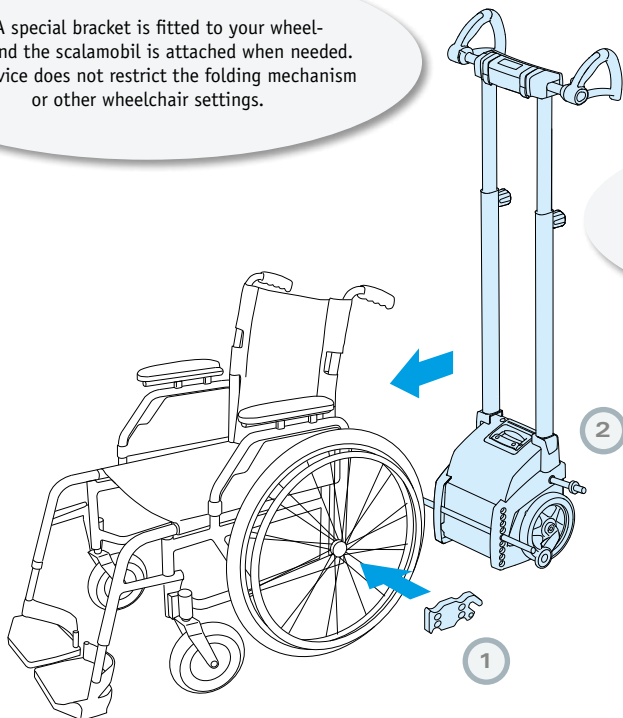

2. It takes just a few twists of the wrist to attach the scalamobil to the wheelchair bracket and secure it.



Universal adapter scalaport for the transport of various types of wheelchairs without any special brackets. Particularly suitable for transport services or public buildings.



# scalacombi

## Climbing the stairs with an integrated seat unit

Perhaps you need assistance to climb the stairs, but don't really need a wheelchair. The stair climber scalacombi will get you upstairs and downstairs with no effort at all. The compact dimensions and steerable front wheels make the scalacombi extremely versatile. It can be easily manoeuvred even in very small rooms and on narrow stairways.

When not in use, the scalacombi can be folded up to save space:

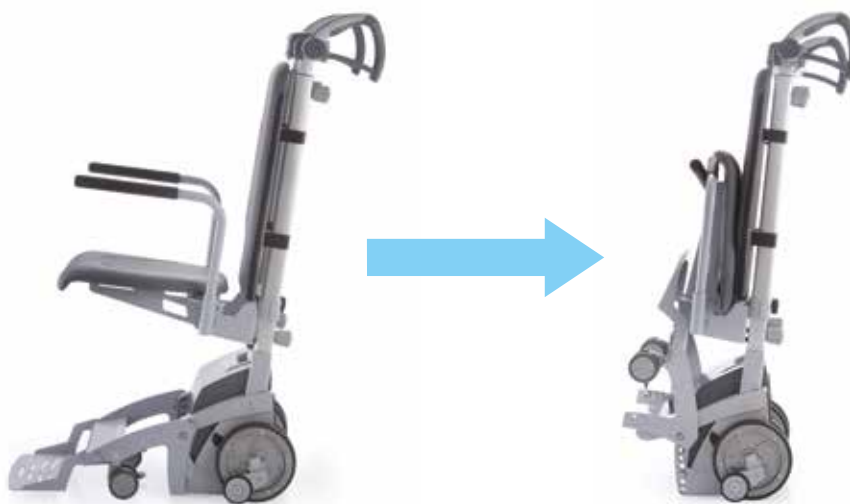

scalamobil and scalacombi also come as special versions for particularly high steps 9.8 inches. There is also a comprehensive range of accessories for all versions (e.g. belt systems, headrests).



## scalamobil and scalacombi – their particular strengths

### Intelligent and safe

The highest degree of safety and comfort when climbing stairs thanks to intelligent electronics: scalamobil and scalacombi can be programmed to adapt to the character of your stairs at home and will then climb them particularly gently and comfortably.

### Easy to operate

With excellent ergonomics, all operating elements are in exactly the right place and the stair climber stays in an optimal position in the hands. This is where Alber's more than 25 years of experience in the development of mobile stair climbers can really be felt and experienced.

### Versatile

scalamobil and scalacombi adapt to your needs – not the other way around. The grip unit can be adjusted in height and width and thus adapts optimally to the person operating it and to the stairs.



ErgoBalance grips: non-slip with a convenient shape



Display showing all functions at a glance



Comfortable cushioning for resting the operating unit on the thigh while climbing the stairs





**“We can now cope with any staircase even when we’re out and about!”**

## **Practical if you are on the move ...**

scalamobil and scalacombi can be used everywhere. Your stair climber can be dismantled in a flash into three compact parts and will even fit in small car boots.

The battery pack can be removed with one hand, is less than 6 lbs light and has enough energy for up to 300 steps with just one battery charge.



## **Safety – wherever you are.**

Safety is our top priority. Which is why our products are constantly inspected by various institutions. By TÜV, for instance, the German Technical Control group which certifies product safety in accordance with the guidelines for medical products. Made in Germany by the market leader for add-on drive systems.



# scalamobil and scalacombi at a glance

## Frequently asked questions and the answers

### Will the scalamobil also fit on my wheelchair?

Yes, the scalamobil fits on nearly all models of wheelchair by means of a small bracket that is mounted just once on the existing wheelchair.

### Do scalamobil and scalacombi also work on spiral staircases?

Yes, and even on different materials such as carpet, wood, stone or metal.

### Could my stairs be damaged?

No, as a result of the unique climbing mechanism and thanks to the abrasion-resistant tyres, the steps are optimally protected.

### How are scalamobil and scalacombi driven?

The quiet electric motors run on a powerful rechargeable battery that is kept operational using a charger.

### How far can I travel with a single charge of the battery?

As a rule, one charge of the battery is enough to climb 300 steps – for a person weighing approx. 154 lbs. That is equivalent to about 20 floors.

### Is a lot of strength needed to operate it?

At the push of a button, the electric motor takes care of all the climbing work. Guiding the scalamobil or scalacombi requires very little strength.

### What is the maximum permitted height and depth of a step?

The steps where a scalamobil is used should be at least 4.3 inches deep and not higher than 7.9 inches. As an option we also offer a step height extension up to 9.8 inches.

### How heavy can a person be who wishes to use the scalamobil or scalacombi as an aid to go up and down stairs?

The person's weight should not exceed 308 lbs.

### Can the scalamobil and scalacombi also be used outside the house?

Basically, the stair climbers can be used on all kinds of steps, whether outdoors or in public buildings. The scalamobil can be dismantled into three parts; it is easy to transport and fits in every car boot.

### How much do scalamobil and scalacombi weigh?

scalamobil drive unit:	38.4 lbs
scalacombi drive unit (incl. seat unit):	65.9 lbs
Battery pack:	5.9 lbs
Grip unit:	10.8 lbs

scalamobil and scalacombi correspond to the EG Directive 93/42/EWG for medical products.

Our quality standards: your safety certified according to the latest standards: ISO 9001:2008 and ISO 13485:2003 for medical products.

Weights	scalamobil/scalacombi
Max. user weight:	308 lbs*
Max. total weight: (incl. scalamobil, wheelchair, wheelchair occupant)	396 lbs*

\* The maximum user weight may vary depending on the used wheelchair and the suitability of the person operating the device.



Alber USA LLC  
1005 International Drive  
Oakdale, PA 15071  
Phone (888) 426-8581  
Fax (724) 695-3710  
info@alber-usa.com  
www.alber-usa.com

“We tried it and  
were instantly won  
over!”

www.alber.de